

HSIIDC REVISED LAYOUT PLAN OF WARE HOUSING & TRANSPORT HUB, PATLI HAZIPUR, IMT MANESAR

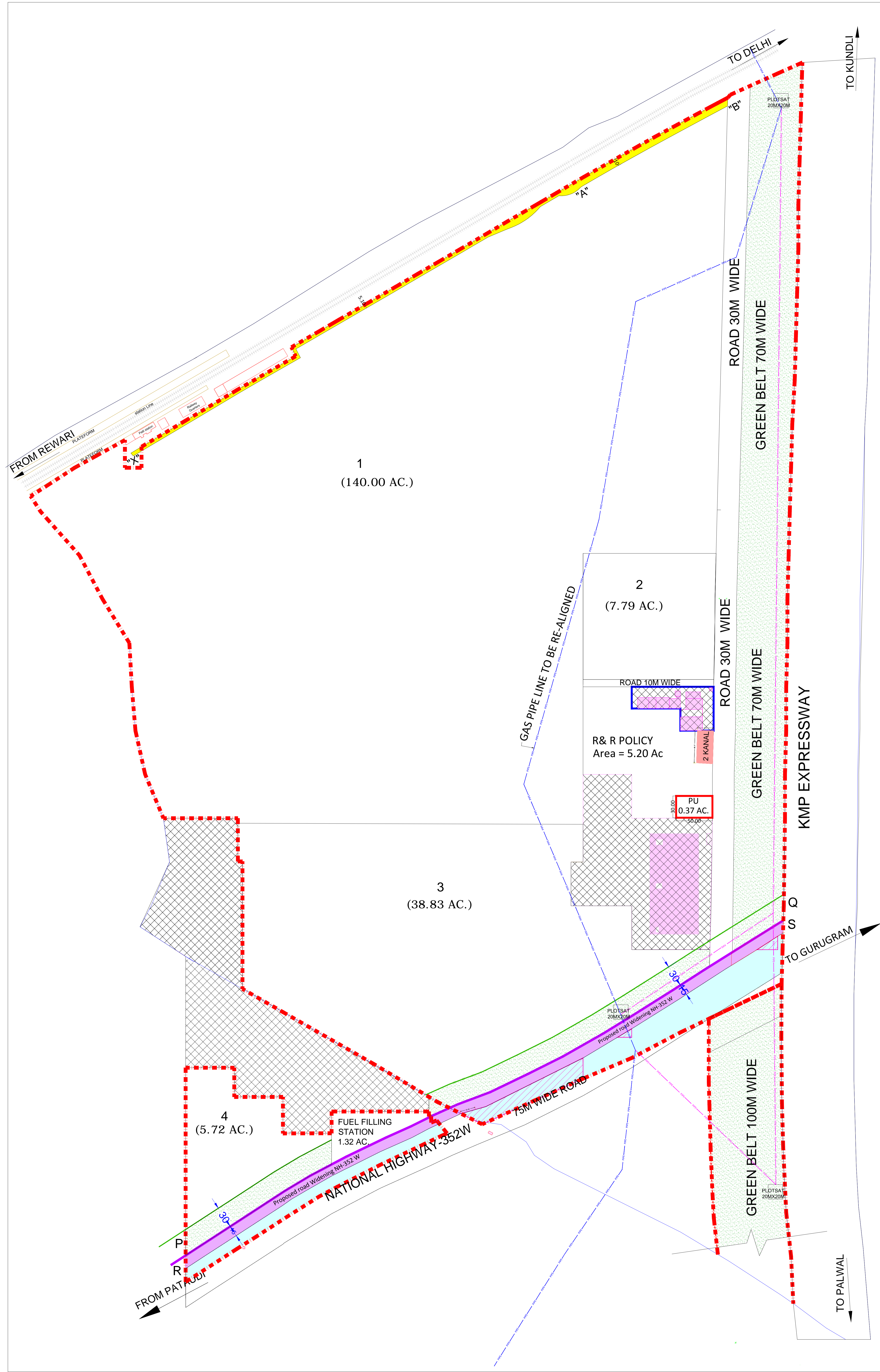

LEGEND

- ACQUISITION BOUNDARY
- RELEASED LAND
- EXISTING GAS PIPE LINE
- PROPOSED GAS PIPE LINE
- GREEN BELT ALONG KMP
- 30M RESTRICTED BELT (AS PER THE PUNJAB SCHEDULED ROADS AND CONTROLLED AREAS RESTRICTION OF UNREGULATED DEVELOPMENT ACT, 1963) ALONG GURGAON TO PATAUDI ROAD
- PART OF 75M WIDE ROAD NH-352W (GURGAON TO PATAUDI) AS PER FDP OF GMUC 2031 AD. NOT ACQUIRED FOR NATIONAL HIGHWAY
- PART OF 75M WIDE ROAD NH-352W (GURGAON TO PATAUDI) AS PER FDP OF GMUC 2031 AD. ACQUIRED BY NHAI
- RASTA AS DEMANDED BY GRAM PANCHAYAT PATLI & JHUND SARAI

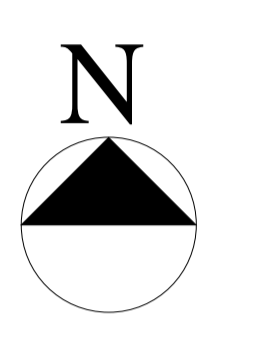

AREA STATEMENT		IN ACRES
1	TOTAL AREA AS PER AWARD DATED 08.02.13.	285.02
2	AREA UNDER WAREHOUSING PLOTS	197.23
3	AREA UNDER R&R POLICY	5.57
4	AREA UNDER FUEL FILLING STATION	1.32
5	AREA ACQUIRED BY NHAI FOR THE WIDENING OF NH 352W (R TO S).	3.04
6	AREA UNDER ROADS & GREEN BELTS ALONGWITH KMP EXPRESS WAY	77.86

DETAIL OF WAREHOUSING PLOTS			
Plot No.	PLOT AREA (IN ACRES)	30M RESTRICTED BELT (IN ACRES)	TOTAL PLOT AREA (IN ACRES)
1	140.00	--	140.00
2	7.79	--	7.79
3	38.83	3.14	41.97
4	5.72	1.75	7.47
TOTAL AREA OF PLOTS			197.23

AS PER HON'BLE COURT ORDER DATED 08.07.2016 RESIDENTIAL PLOT MEASURING 2 KANAL HAS BEEN CARVED OUT IN THE POCKET RESERVED FOR R&R PLOT.

NOTE:-

- THE LAYOUT PLAN APPROVED VIDE DRAWING NO. 1331, DATED 06.08.2020 HAS BEEN REVISED BASED ON THE REPORT RECEIVED FROM DTP/IMT MANESAR VIDE EMAIL DATED 14-12-2020 WHEREIN IT WAS INFORMED THAT OUT OF THE TOTAL AREA I.E. TO 285.02 ACQUIRED FOR WAREHOUSING AND TRANSPORT HUB, PATLI HAZIPUR IMT MANESAR, 4.77 ACRES HAS BEEN ACQUIRED BY NHAI FOR WIDENING OF NH-352W.
- SECONDLY, VIDE MEMO NO.1055 DATED 17-09-2020 AGM(ED), IMT MANESAR INFORMED THAT REVENUE RASTA OF 6KARAM HAS BEEN DEMANDED BY GRAM PANCHAYAT PATLI & JHUND SARAI. ACCORDINGLY A MEETING WAS HELD UNDER THE CHAIRMANSHIP OF DC GURUGRAM AND IT HAS BEEN DECIDED THAT THE REVENUE RASTA OF 3 KARAM FROM THE UNDERPASS NEAR RAILWAY LINE UPTO 100MTR. WIDE GREEN BELT ALONG KMP BE WIDENED TO 6 KARAM (I.E. 10MTRS) FOR THE BETTER MANOEUVREING OF VEHICLES FROM VILLAGE PATLI HAZIPUR AND JHUND SARAI TO PATAUDI ROAD.
- THIRDLY, REMAINING AREA FORMING PART OF 62 ACRES HAS BEEN PLANNED BASED ON THE REFERENCE RECEIVED FROM BDC/HEAD OFFICE.
- THIS PLAN SUBJECT TO ACTUAL DEMARCATION AT SITE.
- THIS DRAWING SUPERCEDES THE PREVIOUS APPROVED DRG. NO. 1331, DATED: 06-08-2020.
- AS PER APPROVAL OF MD HSIIDC BEARING DRG. NO. HSIIDC/IPD/1488, DT. 28.12.2022, SITE FOR PUBLIC UTILITY MEASURING 0.37AC. HAS BEEN INCORPORATED.

DRG. NO. HSIIDC/IPD/1389, DATED: 14.10.2021
 DRAWN BY :- MANOJ KUMAR (-SD-)
 A.T.P.: - POOJA RANI (-SD-)
 D.T.P.: - ANINDERBIR KAUR GREWAL (-SD-)
 S.T.P.: - USHA KIRAN (-SD-)
 C.T.P.: - DINESH SINGH CHAUHAN (-SD-)
 DIRECTOR CONTROLLED AREA CUM MD HSIIDC: - ANURAG AGARWAL (-SD-)